

LEGEND	
COL	DESCRIPTION
	NEW MASONRY
	NEW DRYWALLS
	BASIN WASTE PIPE
	NEW TOILET SOIL / WASTE PIPE
	NEW TOILET AND TIMER DOORS
	NEW GLASS
	NEW BASIN AND WINDOWS

ALL WORK MUST COMPLY WITH THE CURRENT SOUTH AFRICAN NATIONAL BUILDING REGULATIONS, SANS 10400.

COUNCIL SUBMISSION BRIEF 2 RENOVATION PLAN

NOTES:
 Building classification: G3
 Area calculation: 272m²

REVISIONS:	Rev No.	Description	Date

- GENERAL FIRE NOTES:
- Occupancy classification G3 >250 m².
 - All Works to conform to Building Standards Act 103 of 1977 and SANS 10400 Part T -2001.
 - 1 x 4.5kg extinguishers per 200 m² or part thereof to be installed in accordance with SANS 1475-1 / SANS 10105-1 & SANS1151 or as per specialists requirements.
 - 1 x 30m hose reels per 500m² or part thereof to be installed in accordance with SANS 1475-1 / SANS 10105-1 & SANS 1151 or as per specialists requirements.
 - Existing fire services to be extended to new hose reel position/s.
 - Portable fire extinguishers to be hung on purpose-made boards as indicated on plan, installed specialist.
 - Escape doors may only be fitted with approved locking devices.
 - Photo luminescent escape signs to be provided and comply with SANS 1186-1, installed by landlord.
 - Lit Emergency escape signage as required by local authority, installed by specialist.
 - Photo luminescent pictorial signs, indicating fire equipment, to be provided and comply to SANS 1186-1.
 - A manual activated audible alarm in accordance with SANS 10139, to be installed.
 - Roof void subdivision with non-combustible fire stops into areas not exceeding 300m² with brick walls.
 - Suspended ceiling and its supporting members shall be of non-combustible material.
 - Ceiling void subdivision with non-combustible fire stops into areas not exceeding 300m² with dry wall partitioning.
 - The existing sprinkler system will be extended to the underside of the ceiling - if need be.
 - Floor and wall covering to be Class 3.
 - All internal partitioning to be 30mins fire rated as per SANS 10400 Part T no 4.9.
 - Fire detection / emergency evacuation communication system, complying with SANS 10139, to be installed.
 - Stacking height not to exceed 3m.

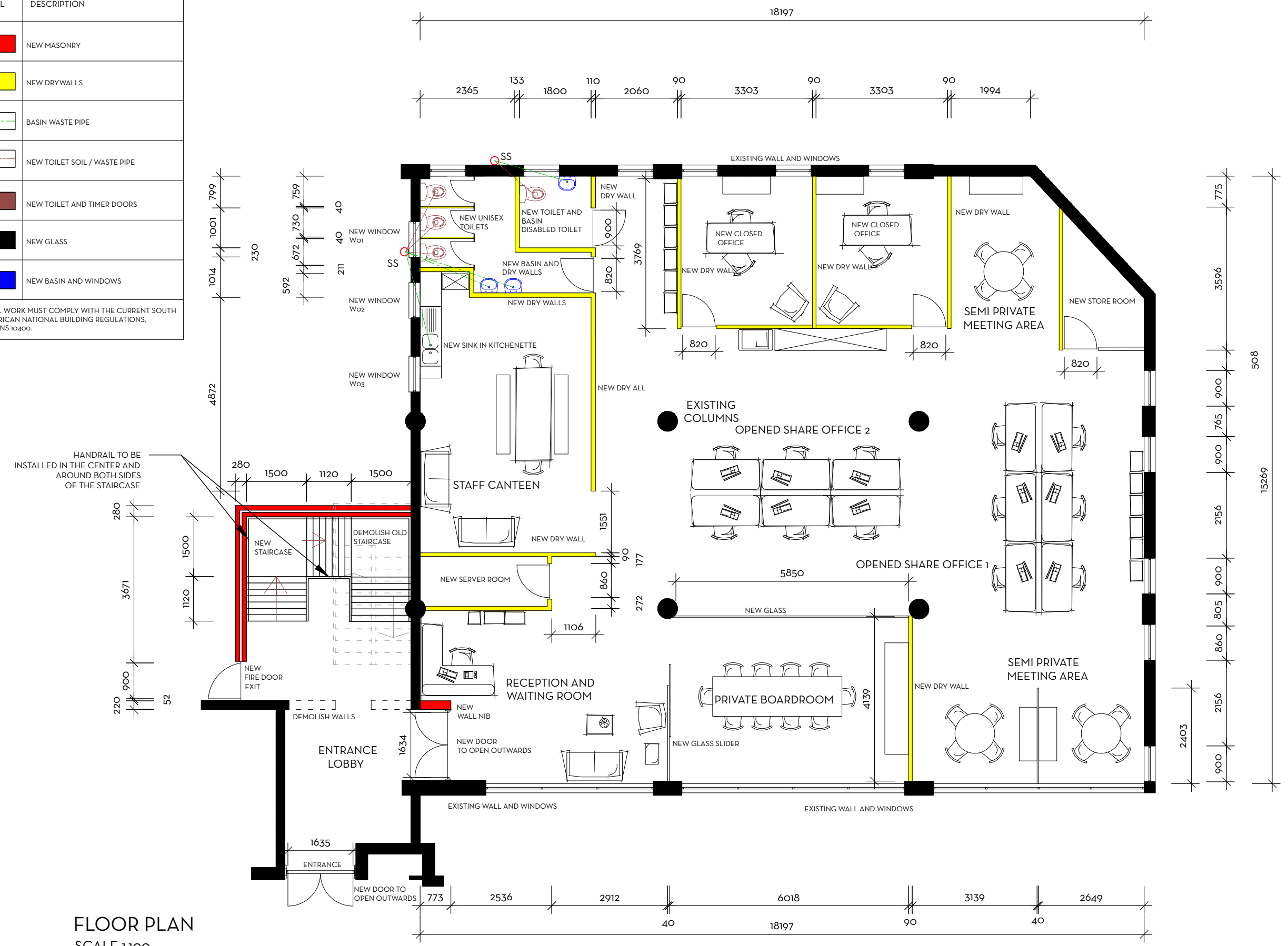

FLOOR PLAN
SCALE 1:100

PROPOSED RENOVATION PLAN

Date: 18 MAY 2016

RENOVATION PLAN

Drawn by: Leighton Clapton
 Plan Number: 1

Paper Size: A3

Design shown is the copyright of the designer.